

# Stair Stone

Pneumatic Machinery & Electric Co.,Ltd.



## Stair Stone

Pneumatic Machinery & Electric Co.,Ltd.

Tel:86-576-88596975

Email:sales@tzsjt.com

www.tzsjt.com

## About Us

### 企业简介

Taizhou Stair Stone Pneumatic Machinery & Electric Co.,Ltd. (Stair Stone---ST-Air One) is a professional manufacturer, specializing in oil-free and low-noise air compressors, pneumatic diaphragm pumps and accessories products. Through the last 10 years, Stair Stone has developed into a company with departments of research & development, manufacturing, quality control and marketing & sales with creative and professional staffs.

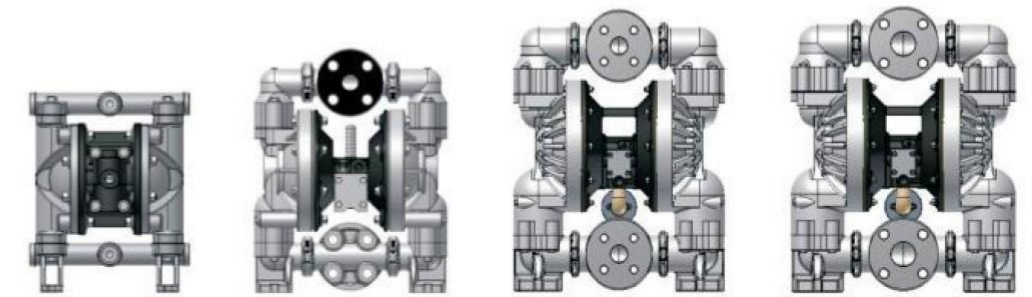
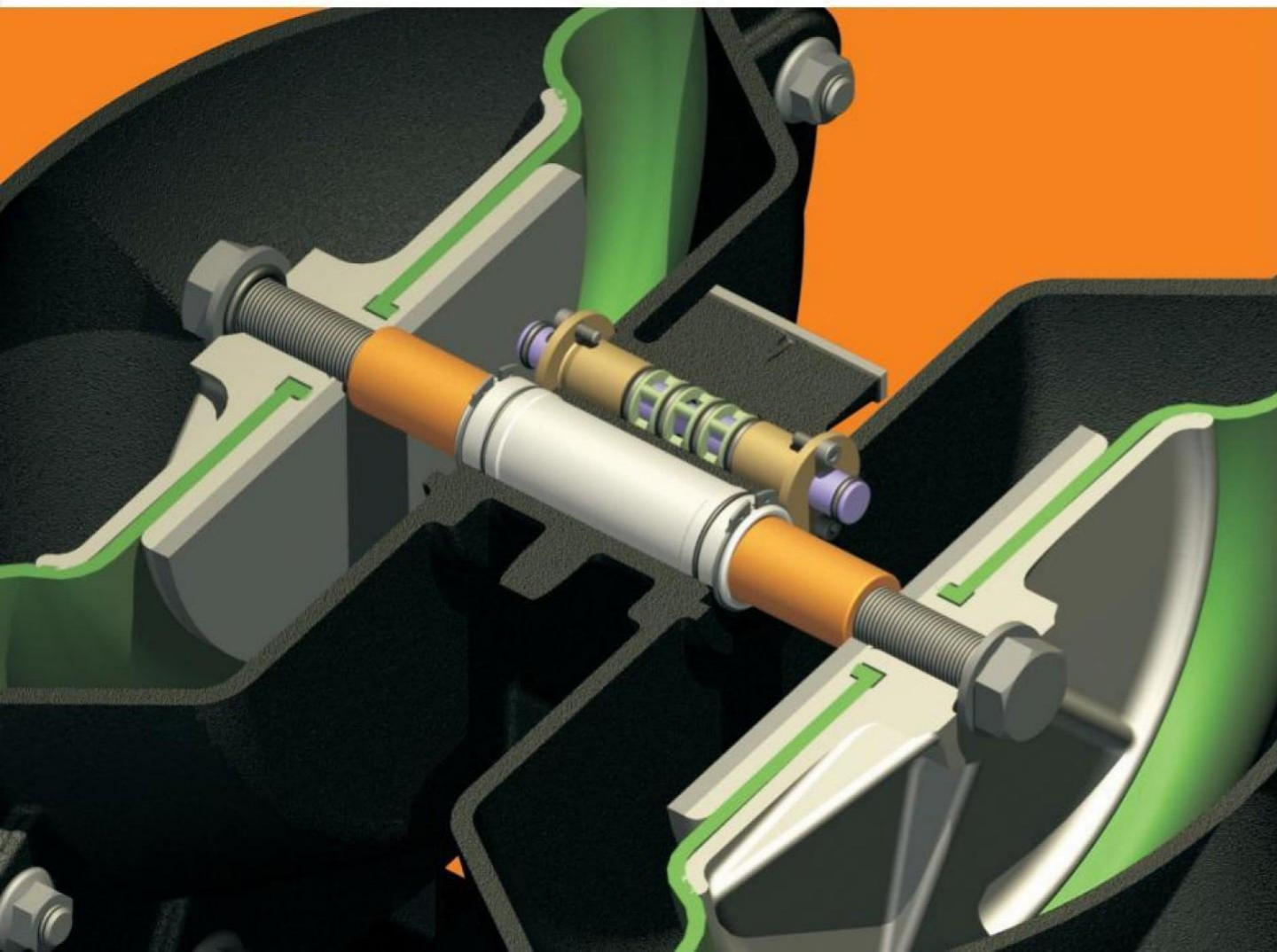

型号 Model	1/2"	1"	1-1/2"	2"
最大流量(升/分钟) Maximum flow (L/M)	54.5	178	378.5	548.8
最大使用气压(BAR) Maximum operating pressure	6.9	8.3	8.3	8.3
流体进出口尺寸 Fluid Ports Inlet/Outlet	1/2"	1"	1-1/2"	2"
马达体材料 Motor Body Material	Polypropylene	Polypropylene	Polypropylene	Polypropylene
水管流体盖材料 Manifold/Fluid Caps Material	Polypropylene Groundable Acetal	Polypropylene	Polypropylene	Polypropylene
重量(KG) Pump Weight	1.9(Y/2PXXX-S) 4.0(Y/2CXXX-S)	9.2(Y-0PXXX-S)	28.1(Y-5PXXX-S)	28.1(E-0PXXX-S)
允许最大颗粒直径(mm) suspended solids max. dia	2.4	3.2	6.4	6.4

# 1/2" Plastic Pump

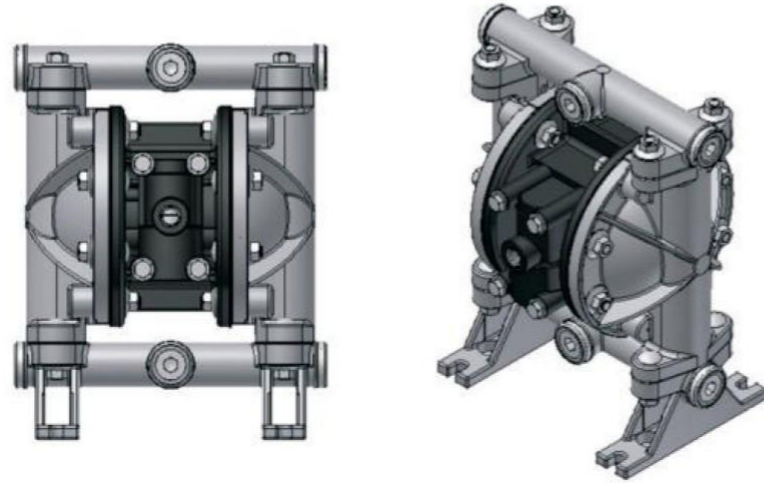

## Basic Parameters

Ratio:	1 : 1	Fluid Outlet:	1/2-14 N.P.T.F.-1
Maximum Flow:	54.5 L/M	Maximum operating pressure:	6.9bar
Displacement per cycle:	0.15 L	Suspended solids max. dia:	2.4mm
Air Inlet:	1/4-18 P.T.F.	Weight:	Y/2PXXX-S 3.3kg
Fluid Inlet:	1/2-14 N.P.T.F.-1		Y/2CXXX-S 4.0kg
	Rp1/2	Maximum dry suction lift:	2.4m

## Ordering Menu

050	X	X	X	X	-S
Fluid Caps/Manifold Material	Seat Material	Ball Material	Diaphragm Material	Means Plastic Series	
P-Polypropylene K-Groundable Acetal	G-Stainless Steel P-Polypropylene D-POM	B-Hytrel T-Teflon G-Stainless Steel U-Polyurethane V-Viton E-E. P. R N-Neoprene S-Santoprane	B-Hytrel T-Teflon H-PTE S-Santoprane V-Viton U-Polyurethane E-E. P. R N-Neoprene		

## Dimensions

All dimensions are for reference only. They are shown in millimeters.

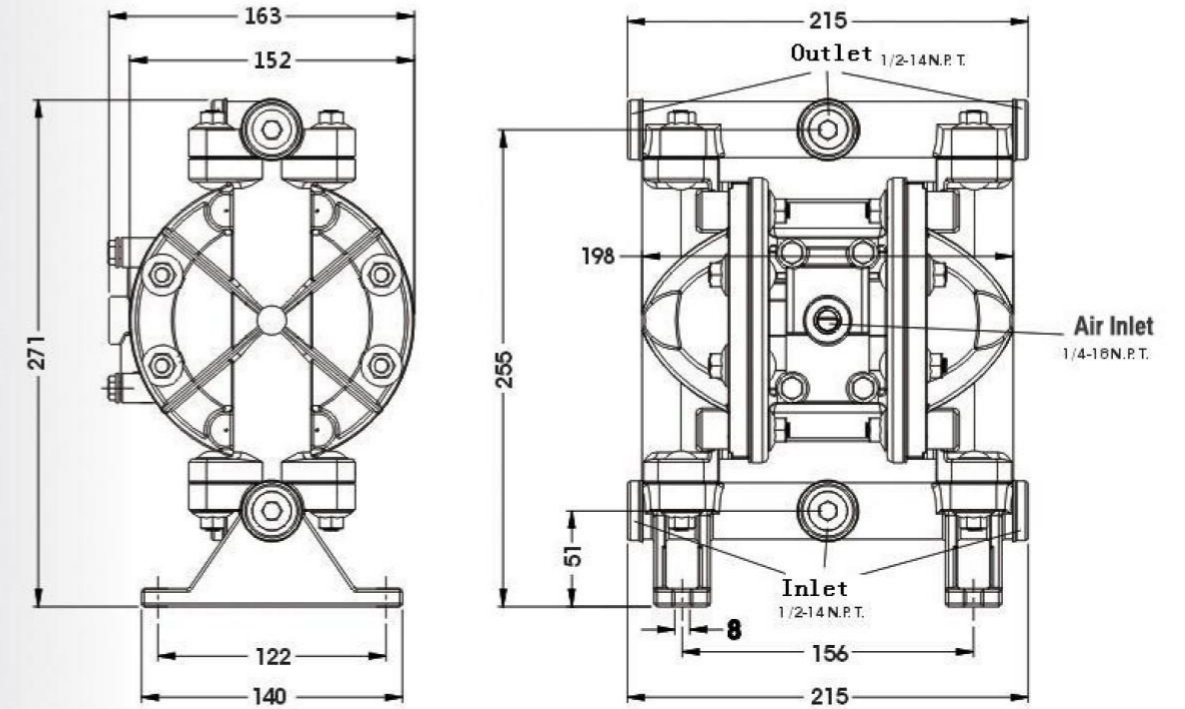

## Performance Curves

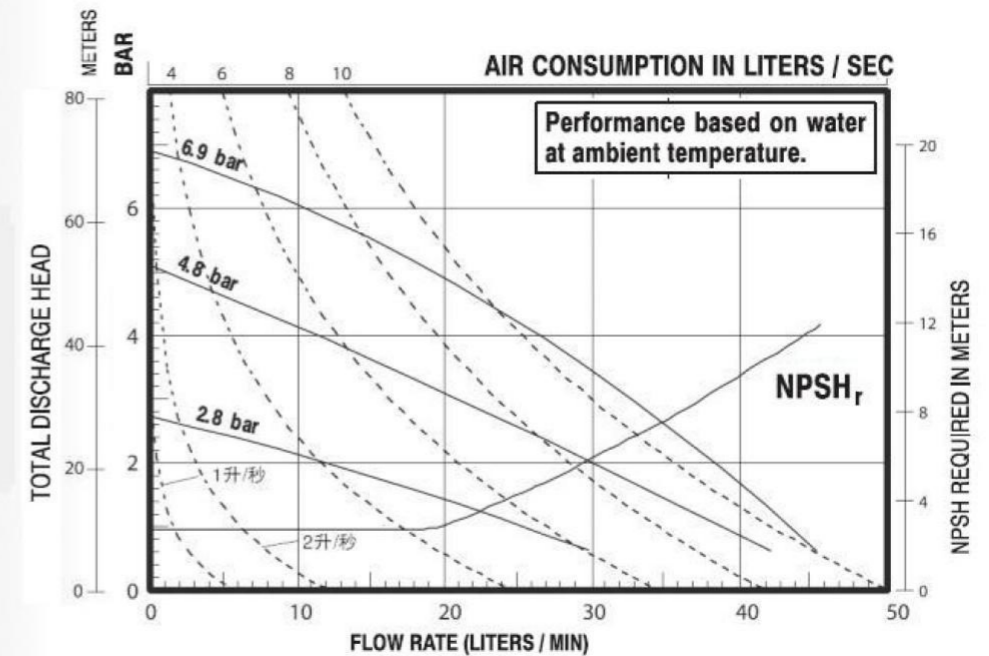

# 1" Plastic Pump

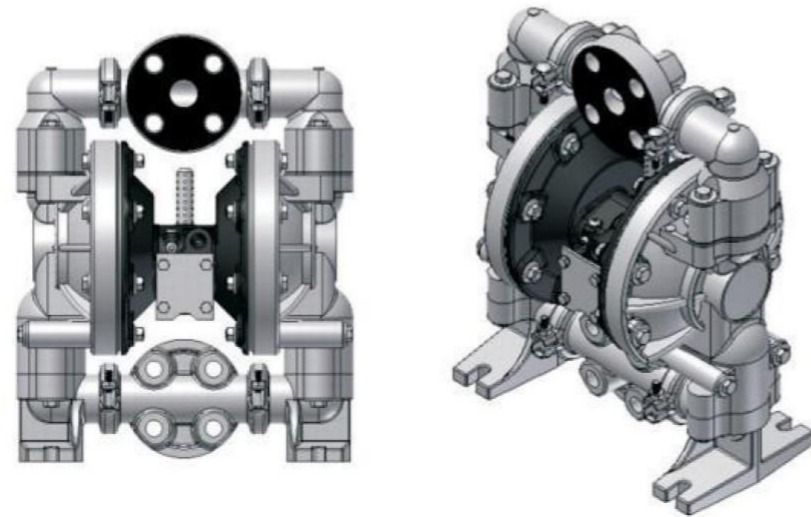

## Dimensions

All dimensions are for reference only. They are shown in millimeters.

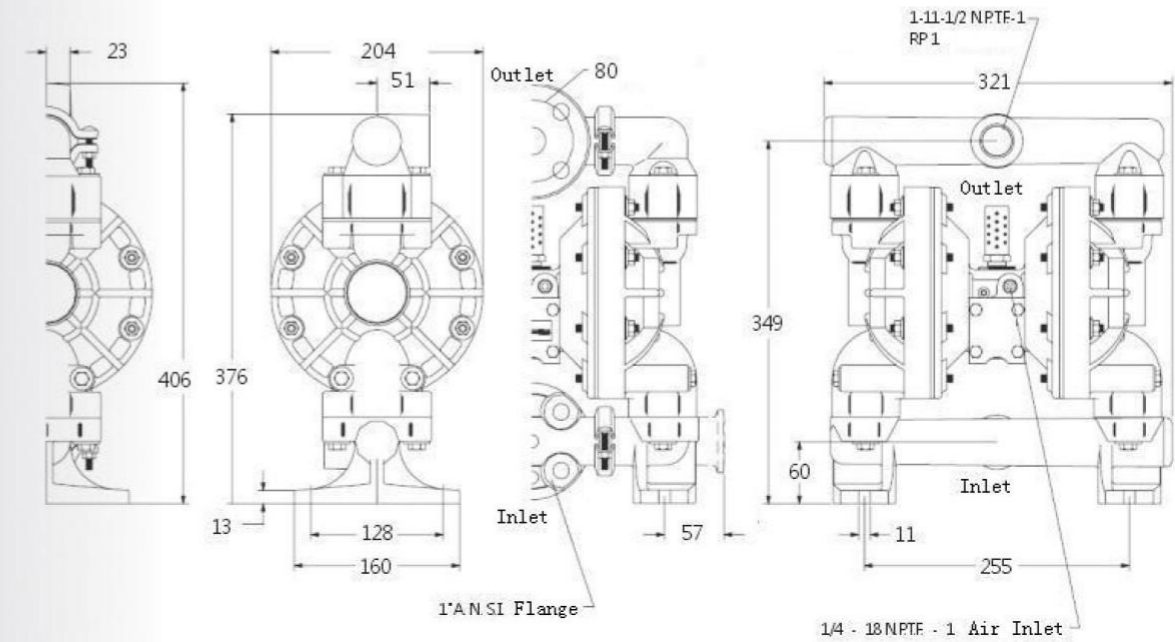

## Basic Parameters

Ratio:	1 : 1	Fluid Outlet:	1-11-1/2 N.P.T.F-1 Rp1
Maximum Flow:	177.9L/M	Maximum operating pressure:	8.3bar
Displacement per cycle:	0.64L	Suspended solids max. dia:	3.2mm
Air Inlet:	1/4-18 N.P.T.	Weight:	Y-OPXXX-S 9.2kg
Fluid Inlet:	1-11-1/2 N.P.T.F-1 Rp1		
	1" A.N.S.I. Flange		

## Ordering Menu

100	X	X	X	X	-S
Fluid Caps/Manifold Material	Seat Material	Ball Material	Diaphragm Material	Means Plastic Series	
P-Polypropylene K-Groundable Acetal	G-Stainless Steel P-Polypropylene Y-Hard Stainless Steel	B-Hytrel T-Teflon G-Stainless Steel U-Polyurethane V-Viton E-E.P.R N-Neoprene S-Santoprane H-PTE	B-Hytrel T-Teflon H-PTE S-Santoprane V-Viton E-E.P.R N-Neoprene		

## Performance Curves

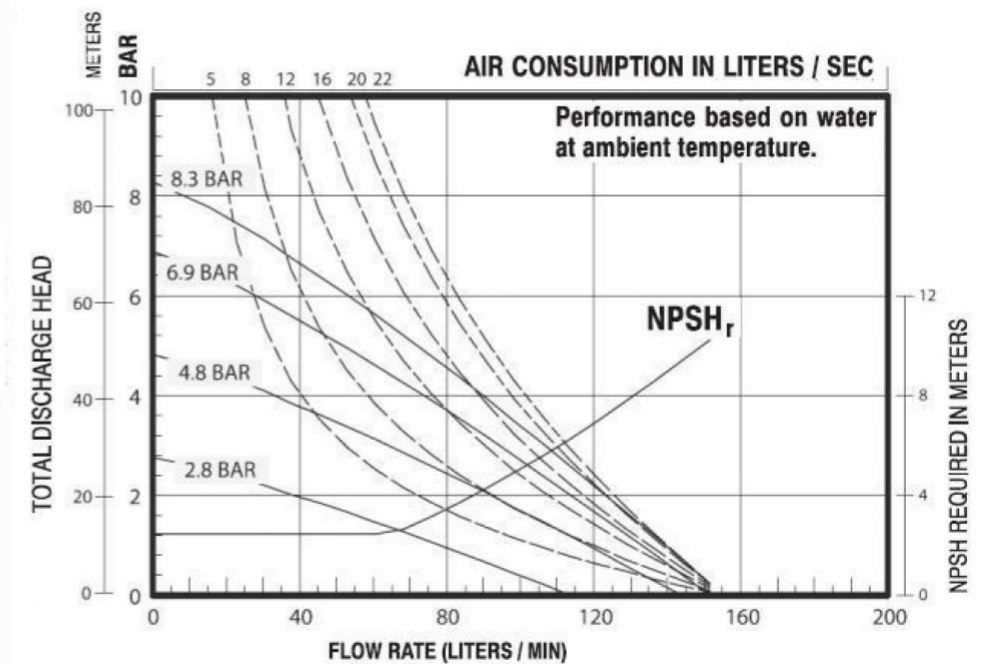

# 1-1/2" Plastic Pump

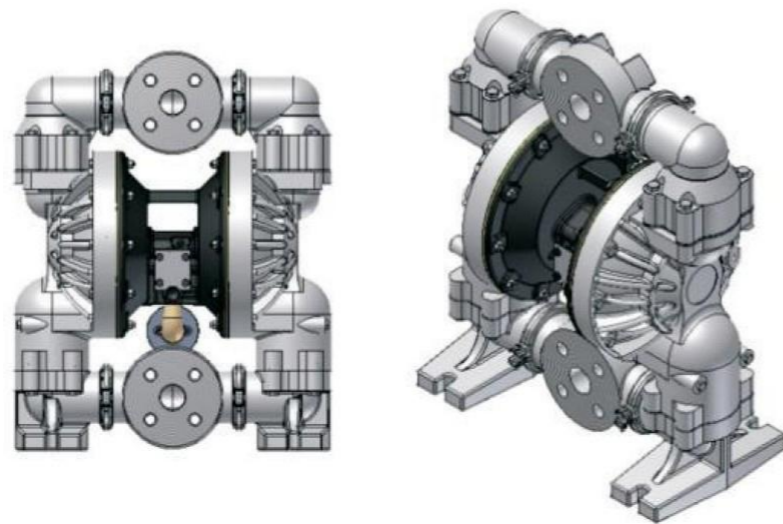

## Dimensions

All dimensions are for reference only. They are shown in millimeters.

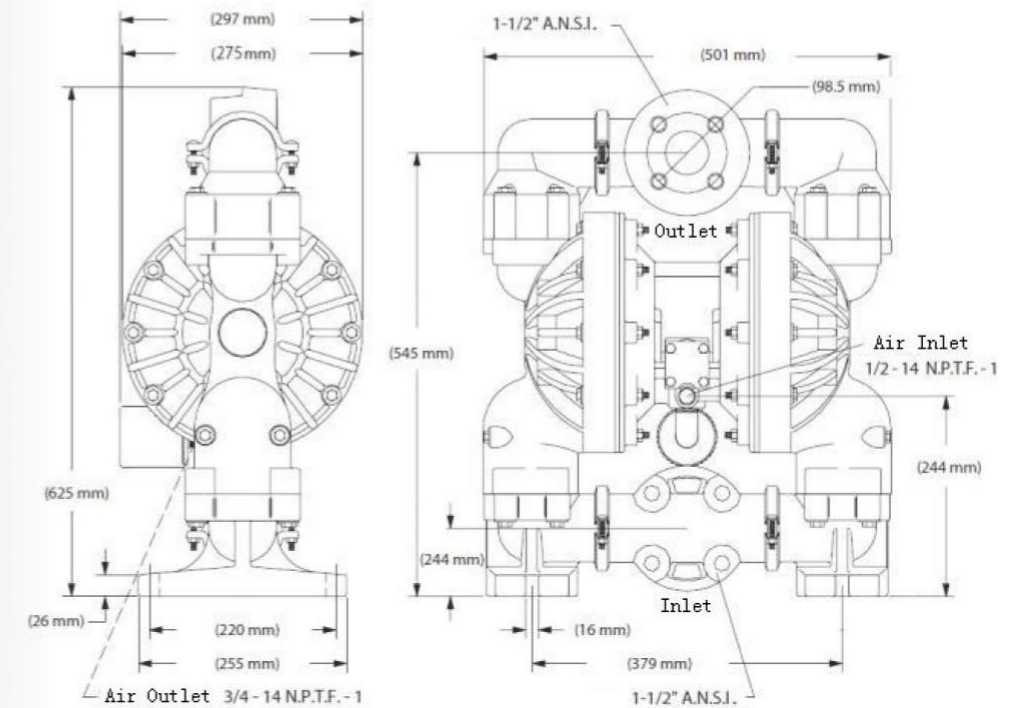

## Basic Parameters

Ratio:	1 : 1	Fluid Outlet:	1-1/2" A.N.S.I. Flange
Maximum Flow:	378.5 L/M	Maximum operating pressure:	8.3bar
Displacement per cycle:	2.54L	Suspended solids max. dia:	6.4mm
Air Inlet:	1/2-14 N.P.T.F.-1	Weight:	Y-5PXXX-S 28.1kg
Fluid Inlet:	1-1/2" Flange	Maximum dry suction lift:	4.27m

## Ordering Menu

150	X	X	X	X	-S
Fluid Caps/Manifold Material	Seat Material	Ball Material	Diaphragm Material	Means Plastic Series	
P-Polypropylene	G-Stainless Steel P-Polypropylene Y-Hard Stainless Steel	B-Hytrel T-Teflon G-Stainless Steel U-Polyurethane V-Viton E-E.P.R N-Neoprene S-Santoprane	B-Hytrel T-Teflon H-PTE S-Santoprane V-Viton E-E.P.R N-Neoprene		

## Performance Curves

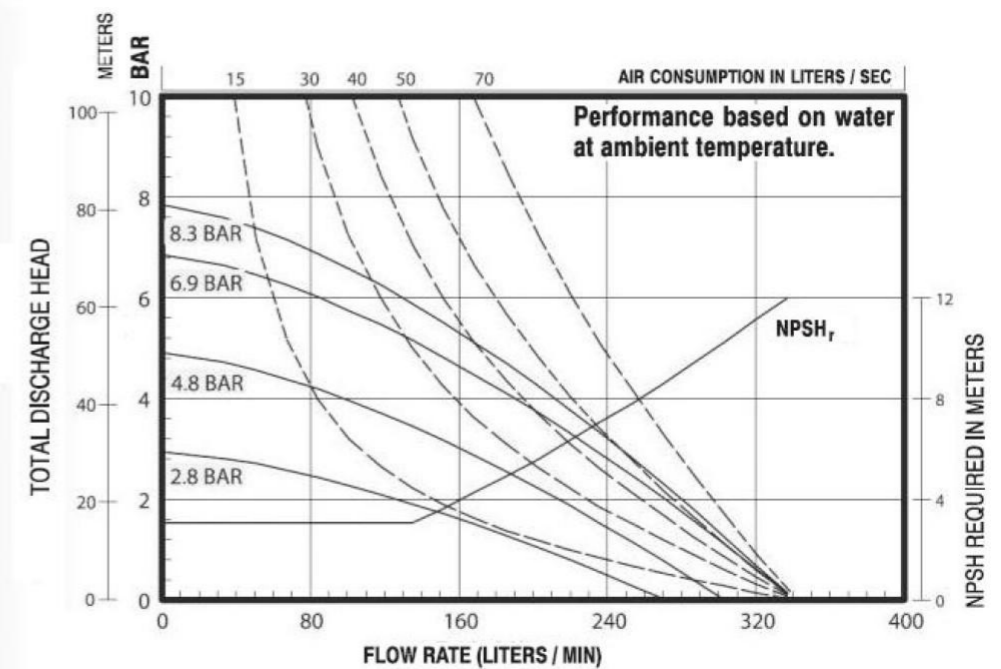

# 2" Plastic Pump

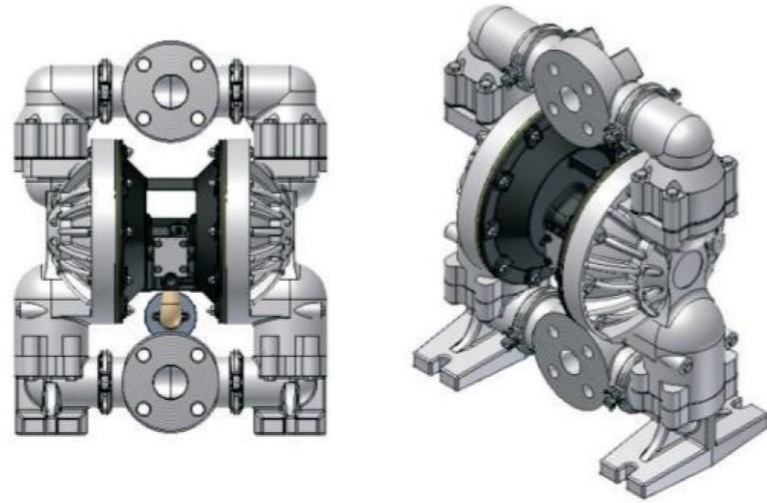

## Dimensions

All dimensions are for reference only. They are shown in millimeters.

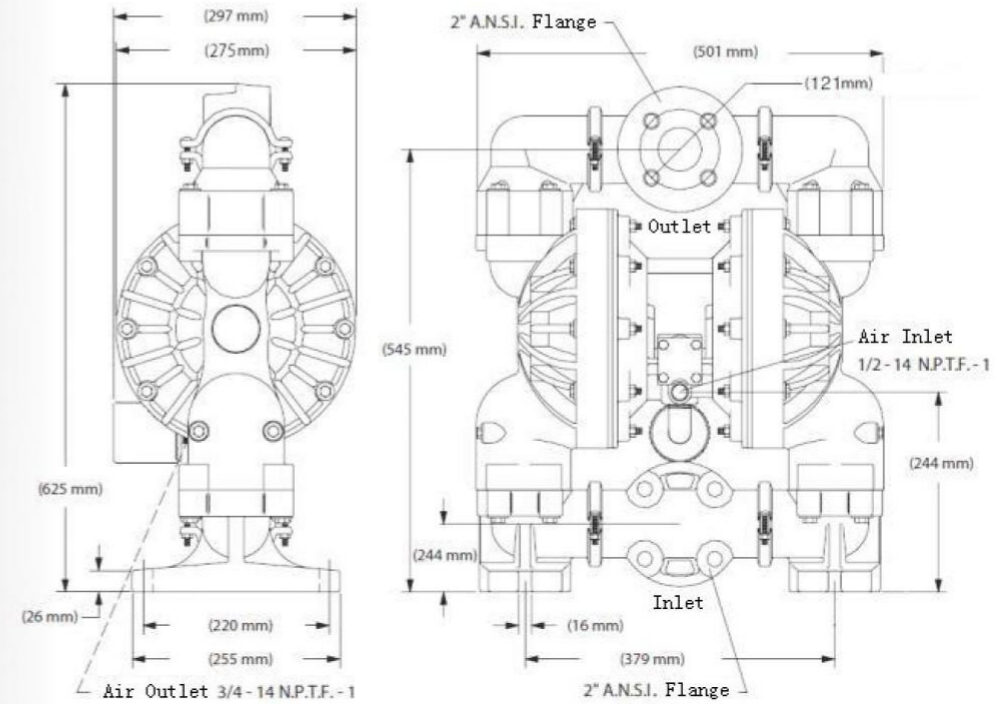

## Basic Parameters

Ratio: 1:1	Fluid Outlet: 2" A.N.S.I. Flange
Maximum Flow: 548.8L/M	Maximum operating pressure: 8.3bar
Displacement per cycle: 2.7L	Suspended solids max. dia: 6.4mm
Air Inlet: 1/2-14 N.P.T.F.-1	Weight: E-OPXXX-S 28.1kg
Fluid Inlet: 2" A.N.S.I. Flange	Maximum dry suction lift: 4.27m

## 订购选项

200	X	X	X	X	-S
Fluid Caps/Manifold Material	Seat Material	Ball Material	Diaphragm Material	Means Plastic Series	
P-Polypropylene	G-Stainless Steel P-Polypropylene Y-Hard Stainless Steel	B-Hytrel T-Teflon G-Stainless Steel U-Polyurethane V-Viton E-E.P.R N-Neoprene S-Santoprene	B-Hytrel T-Teflon H-PTE S-Santoprene V-Viton E-E.P.R N-Neoprene		

## Performance Curves

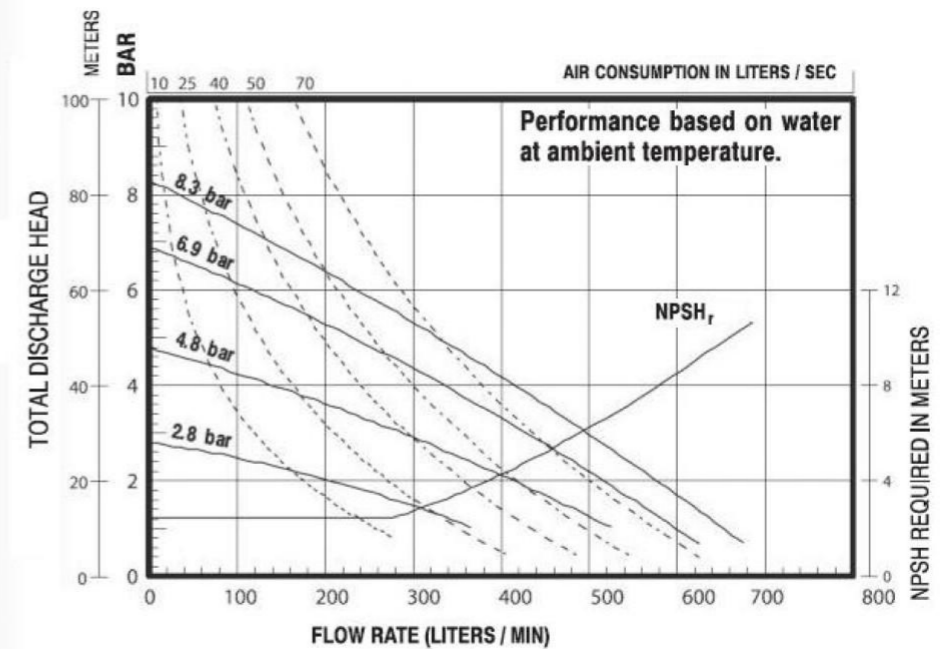



# 1/2" Metallic Pump



Y/2AXXX

Y/2AXXX/Y/2AXXX

### Basic Parameters

Ratio:	1:1	Fluid Outlet:	1/2-14 N.P.T.F-1
Maximum Flow:	45.4 L/M		Rp1/2
Displacement per cycle:	0.15L	Maximum operating pressure:	6.9bar
Air Inlet:	1/4-18 N.P.T.F-1	Suspended solids max. dia:	2.4mm
Fluid Inlet:	1/2-14 N.P.T.F-1	Weight:	Y/2AXXX 3.8kg
	Rp1/2		Y/2GXXX 6.6kg
			Y/2ZXXX 6.2kg
		Maximum dry suction lift:	2.8m

### Ordering Menu

050	X	X	X	X
	Fluid Caps/Manifold Material	Seat Material	Ball Material	Diaphragm Material
	A-Aluminum G-Stainless Steel Z-Cast Iron	A-Aluminum G-Stainless Steel P-Polypropylene	B-Hytrel T-Teflon G-Stainless Steel V-Viton S-Santoprane	B-Hytrel T-Teflon S-Santoprane V-Viton

### Dimensions

All dimensions are for reference only. They are shown in millimeters.

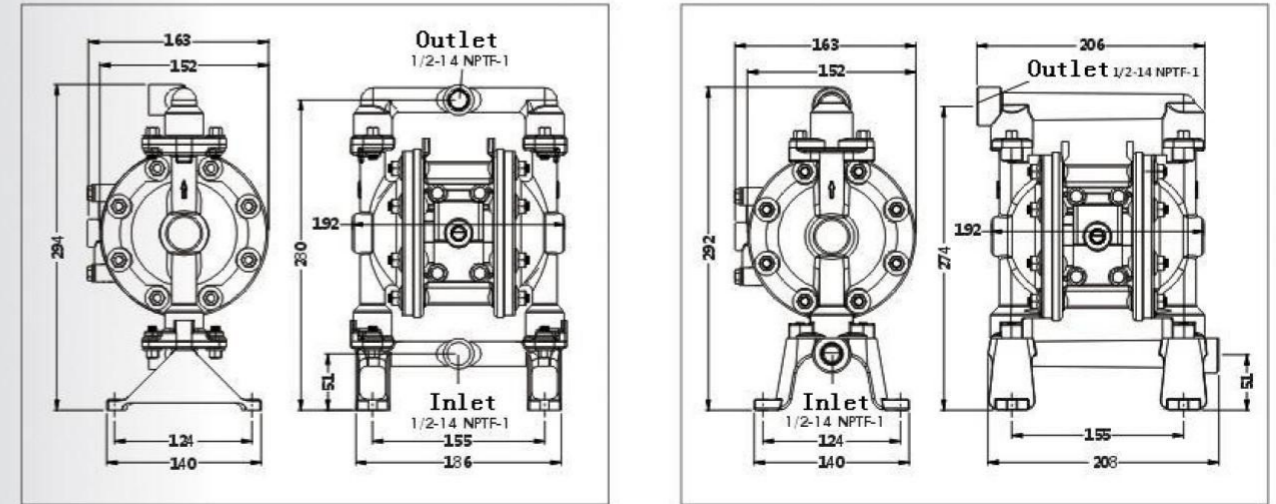

Y/2AXXX

Y/2GXXX/Y/2ZXXX

### Performance Curves

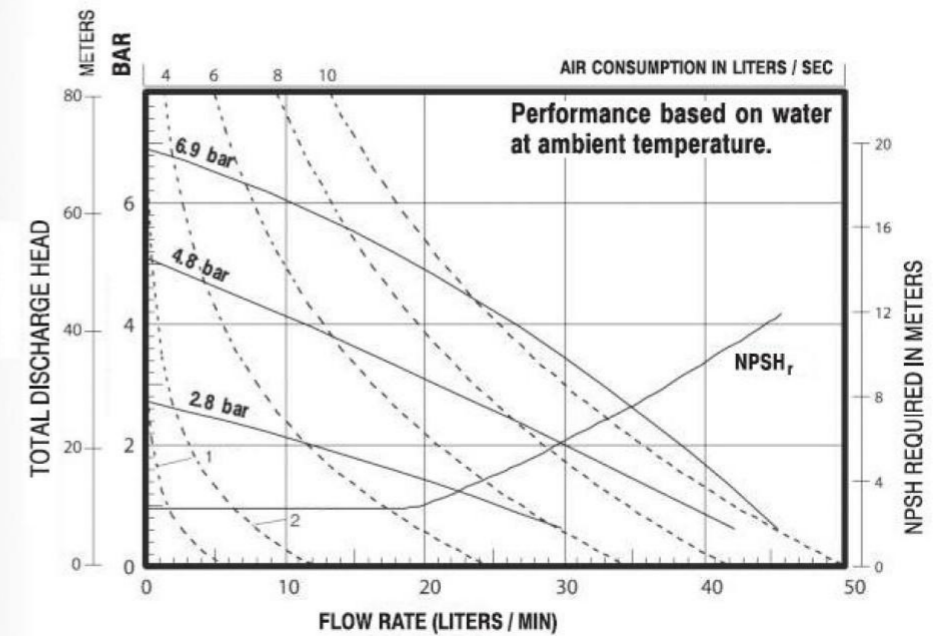



# 1" Metallic Pump

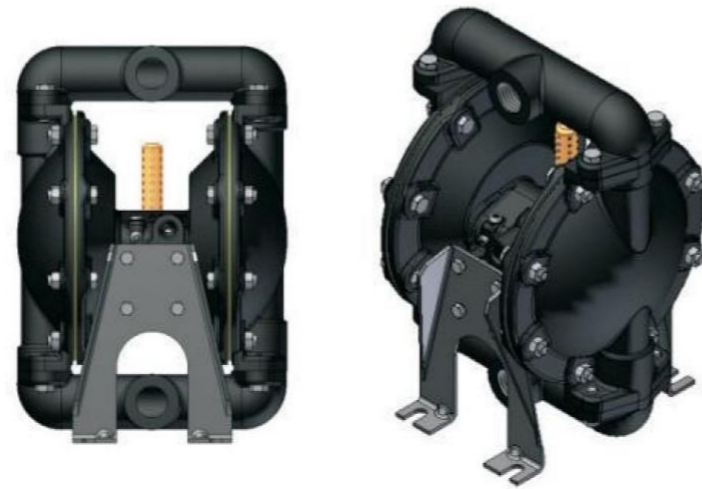

## Basic Parameters

Ratio:	1:1	Fluid Outlet:	1-11-1/2 N.P.T.F-1
Maximum Flow:	133 L/M		Rp1
Displacement per cycle:	0.6L	Maximum operating pressure:	8.3bar
Air Inlet:	1/4-18 N.P.T.F-1	Suspended solids max. dia:	3.2mm
Fluid Inlet:	1-11-1/2 N.P.T.F-1	Weight:	Y-0XAXXXX 8.6kg
	Rp1		Y-0XGXXXX 16.3kg
			Y-0XZXXXX 14.1kg
		Maximum dry suction lift:	6.1m

## Ordering Menu

100	X	X	X	X	X
Pipe thread	Fluid Caps/Manifold Material	Seat Material	Ball Material	Diaphragm Material	Hardware Material
C--1-11 1/2 NPTF-1 R--Rp	A-Aluminum G-Stainless Steel Z-Cast Iron	A-Aluminum G-Stainless Steel P-Polypropylene C-Carbon Steel Y-Hard Stainless Steel	B-Hytrel T-Teflon G-Stainless Steel U-Polyurethane V-Viton E-E.P.R N-Neoprene S-Santoprane H-PTE D-POM	B-Hytrel T-Teflon H-PTE S-Santoprane V-Viton E-E.P.R N-Neoprene	C-Carbon Steel G-Stainless Steel

## Dimensions

All dimensions are for reference only. They are shown in millimeters.

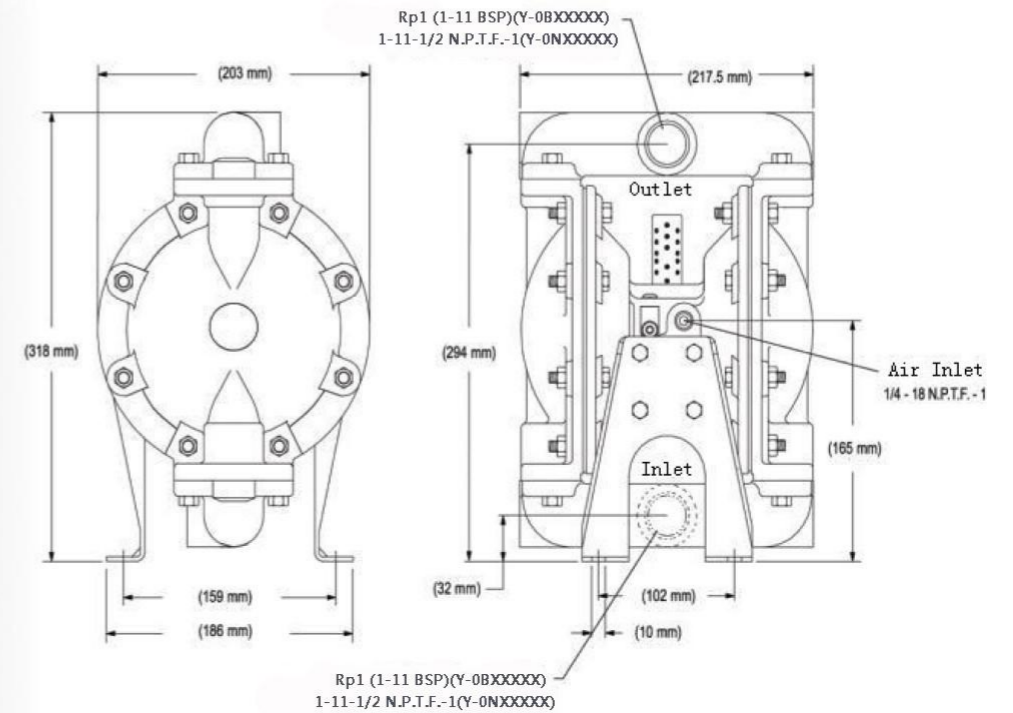

## Performance Curves

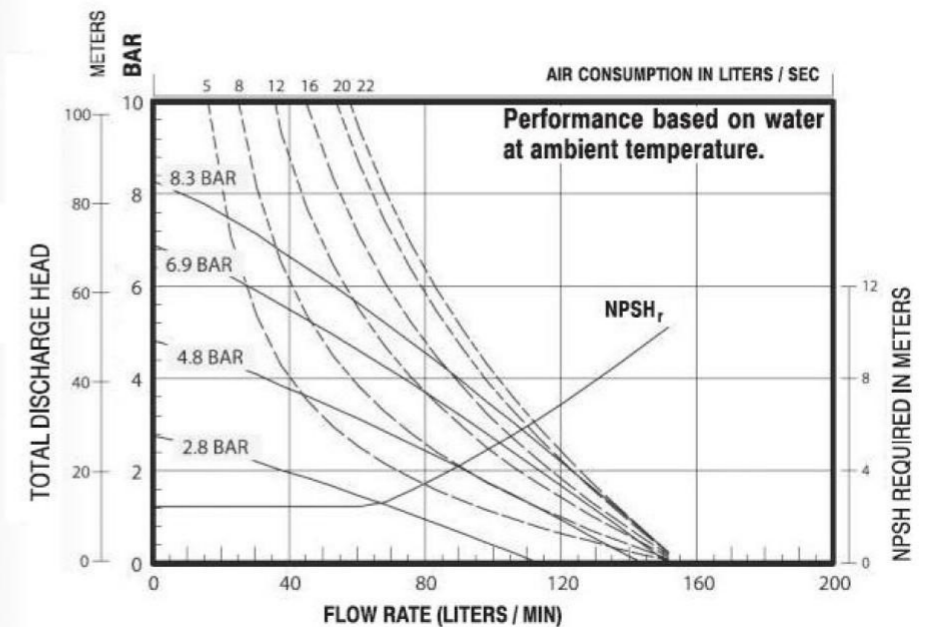

# 1-1/2" Metallic Pump



## Basic Parameters

Ratio:	1:1	Fluid Outlet:	1-1/2 11-1/2 N.P.T.F-1
Maximum Flow:	340.7 L/M	Maximum operating pressure:	8.3bar
Displacement per cycle:	2.42L	Suspended solids max. dia:	6.4mm
Air Inlet:	1/2-14 N.P.T.F-1	Weight:	Y-5XAXXXX 23.4kg
Fluid Inlet:	1-1/2 11-1/2 N.P.T.F-1		Y-5XGXXXX 38.3kg
	Rp1-1/2		Y-5XZXXXX 36.1kg
		Maximum dry suction lift:	5.8m

## 订购选项

150	X	X	X	X	X
Pipe thread	Fluid Caps/Manifold Material	Seat Material	Ball Material	Diaphragm Material	Hardware Material
C--1-11 1/2 NPTF-1 R--Rp	A-Aluminum G-Stainless Steel Z-Cast Iron	A-Aluminum G-Stainless Steel P-Polypropylene C-Carbon Steel Y-Hard Stainless Steel	B-Hytrel T-Teflon G-Stainless Steel U-Polyurethane V-Viton E-E.P.R N-Neoprene S-Santoprane H-PTE D-POM	B-Hytrel T-Teflon H-PTE S-Santoprane V-Viton E-E.P.R N-Neoprene	C-Carbon Steel G-Stainless Steel

## Dimensions

All dimensions are for reference only. They are shown in millimeters.

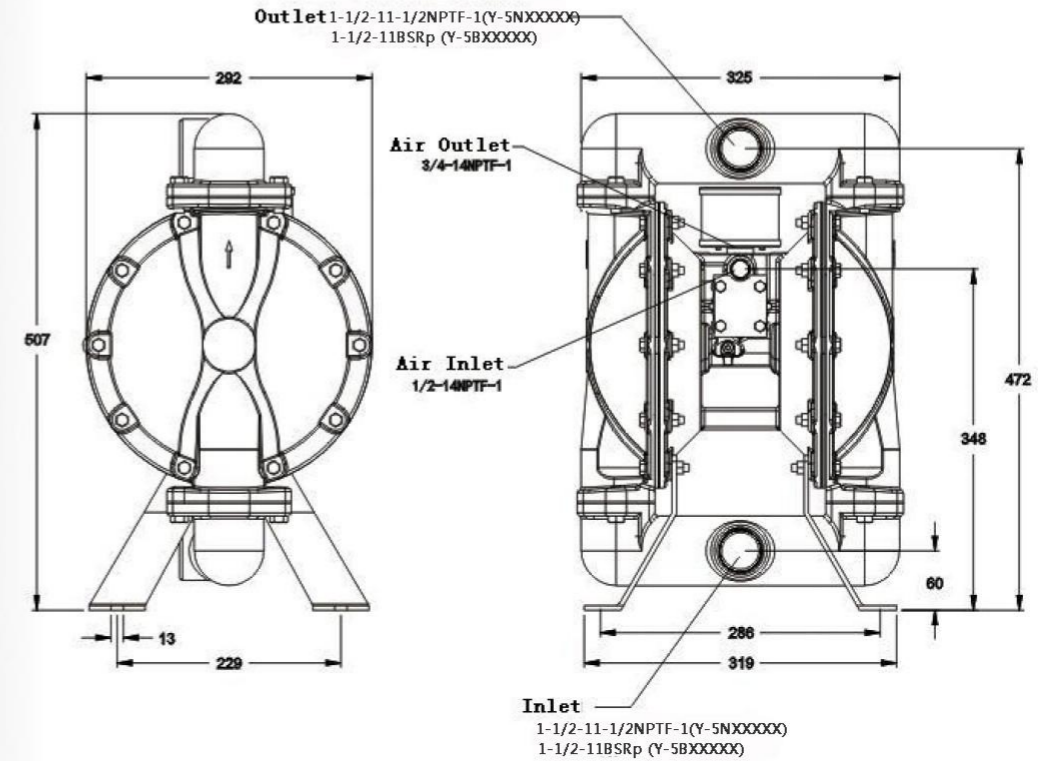

## Performance Curves

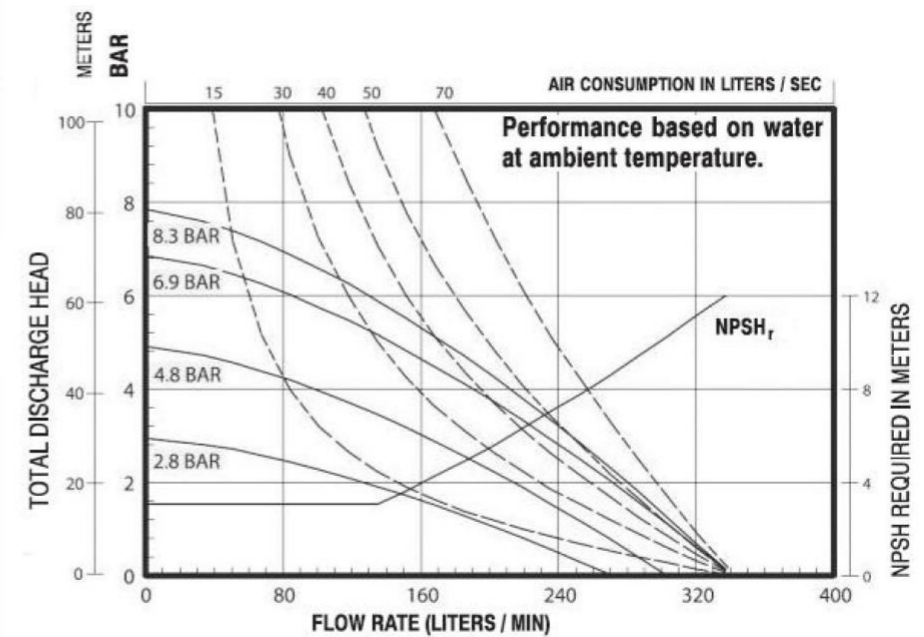

# 2" Metallic Pump



### Basic Parameters

Ratio:	1:1	Fluid Outlet:	2-11-1/2 N.P.T.F-1
Maximum Flow:	651L/M		Rp2
Displacement per cycle:	5.3L	Maximum operating pressure:	8.3bar
Air Inlet:	3/4-14 N.P.T.F-1	Suspended solids max. dia:	6.4mm
Fluid Inlet:	2-11-1/2 N.P.T.F-1	Weight:	E-0XAXXXX 25kg
	Rp2		E-0XGXXXX 57kg
			E-0XZXXXX 55kg
		Maximum dry suction lift:	8.3m

### 订购选项

200	X	X	X	X	X
Pipe thread	Fluid Caps/Manifold Material	Seat Material	Ball Material	Diaphragm Material	Hardware Material
C--1-11 1/2 NPTF-1 R--Rp	A-Aluminum G-Stainless Steel Z-Cast Iron	A-Aluminum G-Stainless Steel P-Polypropylene C-Carbon Steel Y-Hard Stainless Steel	B-Hytrel T-Teflon G-Stainless Steel U-Polyurethane V-Viton E-E.P.R N-Neoprene S-Santoprene H-PTE D-POM	B-Hytrel T-Teflon H-PTE S-Santoprene V-Viton E-E.P.R N-Neoprene	C-Carbon Steel G-Stainless Steel

### Dimensions

All dimensions are for reference only. They are shown in millimeters.

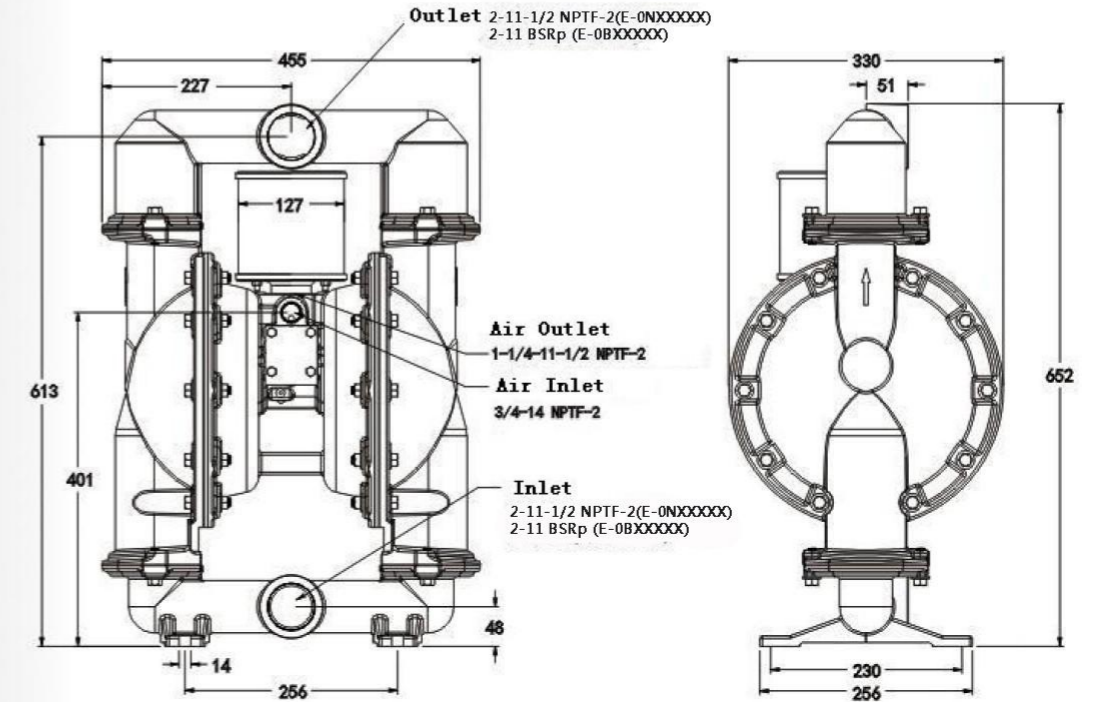

### Performance Curves

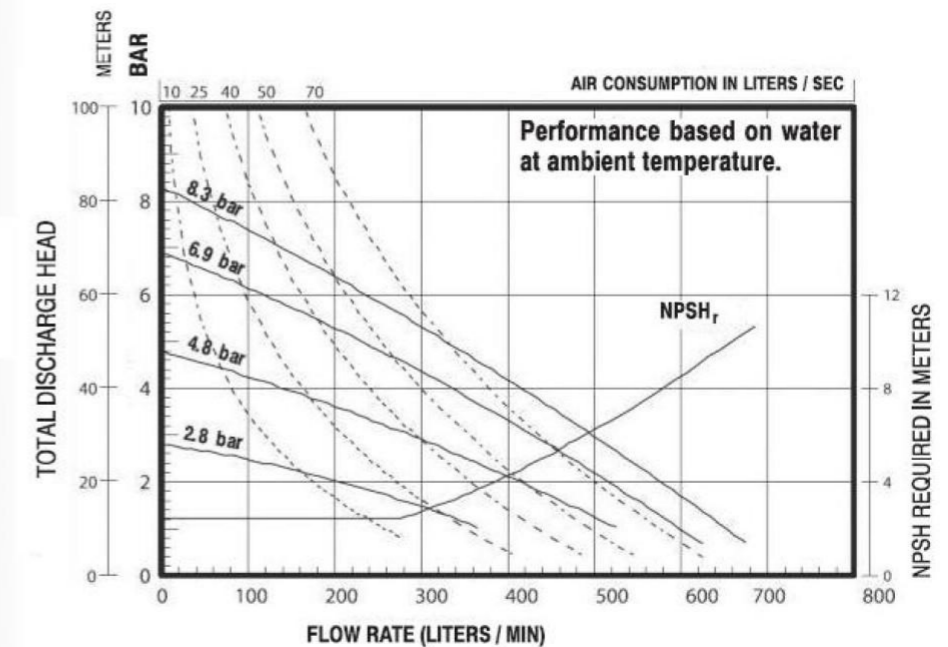

# 3" Metallic Pump



## Basic Parameters

Ratio:	1 : 1	Fluid Outlet:	3-8 N.P.T.F.-1
Maximum Flow:	897 L/M		Rp3
Displacement per cycle:	10L	Maximum operating pressure:	8.3bar
Air Inlet:	3/4-14 N.P.T.F.-1	Suspended solids max. dia:	9.5mm
Fluid Inlet:	3-8 N.P.T.F.-1	Weight:	S-0XAXXXX 48kg
	Rp3		S-0XGXXXX 100kg
			S-0XZXXXX 95kg
		Maximum dry suction lift:	5.4m

## Ordering Menu

300	X	X	X	X	X
Pipe thread	Fluid Caps/Manifold Material	Seat Material	Ball Material	Diaphragm Material	Hardware Material
C--1-11 1/2 NPTF-1 R--Rp	A-Aluminum G-Stainless Steel Z-Cast Iron	A-Aluminum G-Stainless Steel P-Polypropylene C-Carbon Steel Y-Hard Stainless Steel	B-Hytrel T-Teflon G-Stainless Steel U-Polyurethane V-Viton E-E.P.R N-Neoprene S-Santoprane H-PTE D-POM	B-Hytrel T-Teflon H-PTE S-Santoprane V-Viton E-E.P.R N-Neoprene	C-Carbon Steel G-Stainless Steel

## Dimensions

All dimensions are for reference only. They are shown in millimeters.

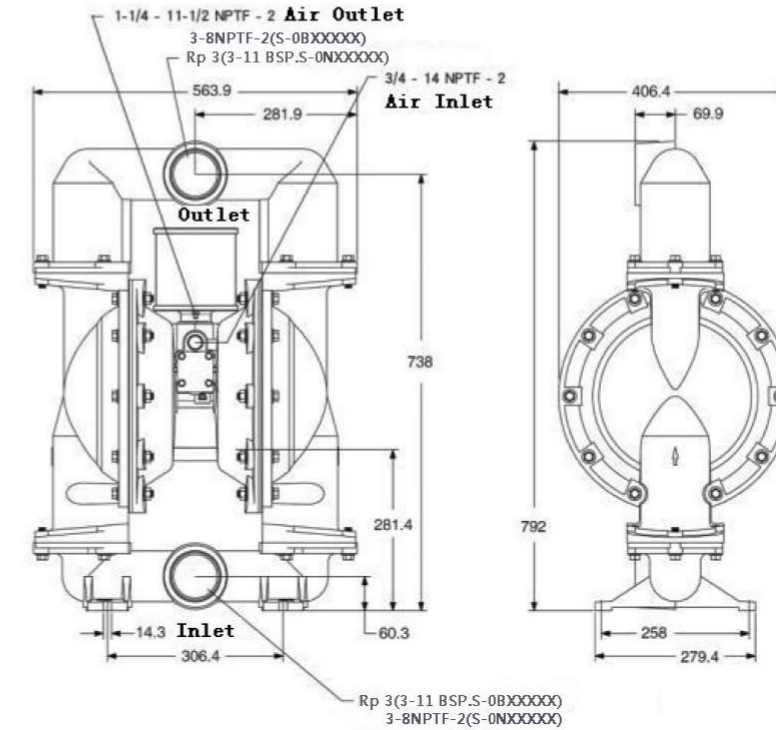

## Performance Curves

